

Pressure Regulator & Damper Assembly

FUEL INJECTION (FUEL SYSTEMS)

34. Pressure Regulator & Damper Assembly

A: REMOVAL

WARNING:

Place "NO OPEN FLAMES" signs near the working area.

CAUTION:

- Be careful not to spill fuel.
- Catch the fuel from hoses using a container or cloth.

1) Release the fuel pressure. <Ref. to FU(STI)-64, RELEASING OF FUEL PRESSURE, PROCEDURE, Fuel.>

2) Disconnect the vacuum hose (A) from the pressure regulator and damper assembly.

3) Disconnect the fuel return hose (B) and fuel hose (C) from the pressure regulator & damper assembly, and remove the fuel regulator & damper assembly.

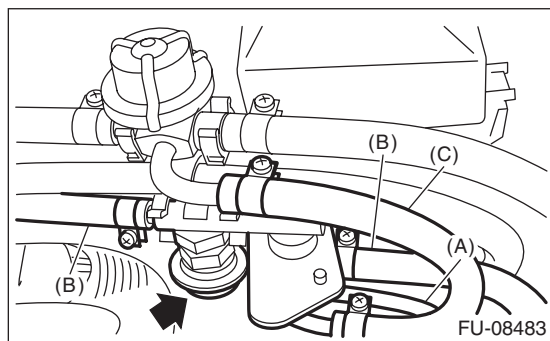

B: INSTALLATION

Install in the reverse order of removal.

NOTE:

For the information about connecting the fuel return hose and fuel hose, refer to "Fuel Delivery, Return and Evaporation Lines". <Ref. to FU(STI)-99, CONNECTING FUEL DELIVERY HOSE, FUEL RETURN HOSE AND FUEL HOSE, INSTALLATION, Fuel Delivery, Return and Evaporation Lines.>

C: DISASSEMBLY

1) Remove the fuel pipe protector from the pressure regulator and damper assembly.

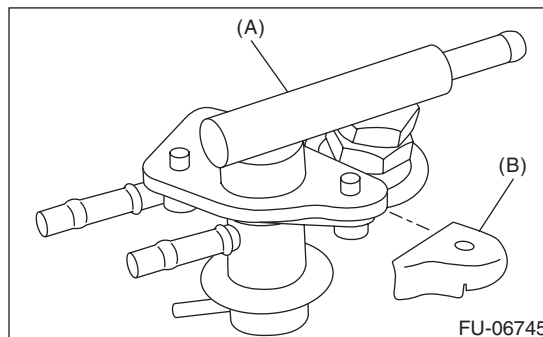

(A) Pressure regulator & damper ASSY

(B) Fuel pipe protector

2) Remove the pulsation damper and fuel pipe gasket from the fuel holder assembly, and remove the pressure regulator from the fuel holder assembly.

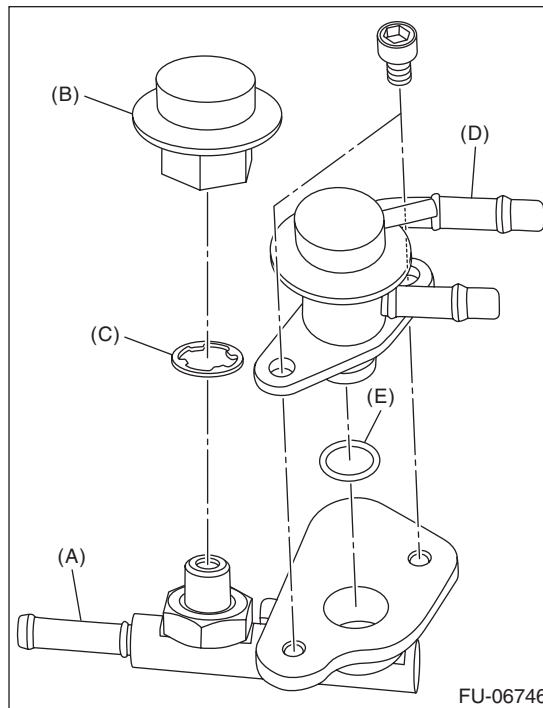

(A) Fuel holder ASSY

(B) Pulsation damper

(C) Fuel pipe gasket

(D) Pressure regulator

(E) O-ring

Pressure Regulator & Damper Assembly

FUEL INJECTION (FUEL SYSTEMS)

D: ASSEMBLY

1) Install the pressure regulator to the fuel holder assembly, and install the fuel pipe gasket and pulsation damper to the fuel holder assembly.

NOTE:

- Use new O-rings and fuel pipe gaskets.
- Apply a thin coat of engine oil to the pressure regulator installation hole of fuel holder assembly.

Tightening torque:

T1: 6.4 N·m (0.7 kgf-m, 4.7 ft-lb)

T2: 21.6 N·m (2.2 kgf-m, 15.9 ft-lb)

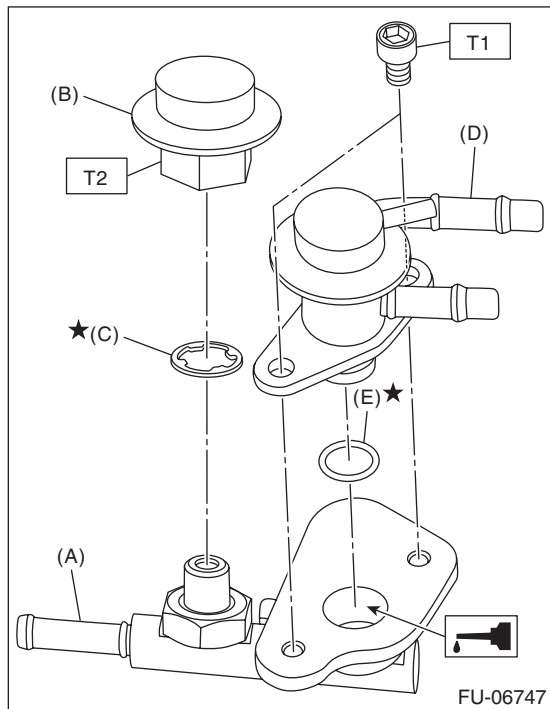

- (A) Fuel holder ASSY
- (B) Pulsation damper
- (C) Fuel pipe gasket
- (D) Pressure regulator
- (E) O-ring

2) Install the fuel pipe protector to the pressure regulator and damper assembly.

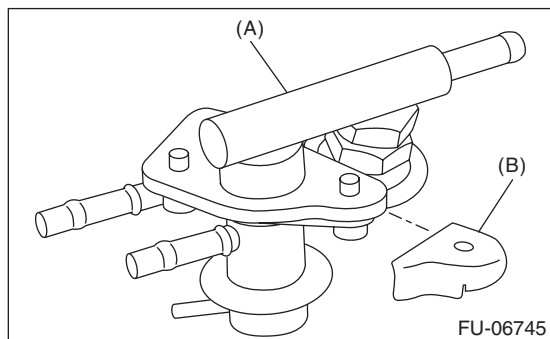

- (A) Pressure regulator & damper ASSY
- (B) Fuel pipe protector

E: INSPECTION

- 1) Check that the pressure regulator and damper assembly has no deformation, cracks or other damages.
- 2) Check that the vacuum hose, fuel return hose and fuel hose have no cracks, damage or loose part.